



ALFRA = NOTCH PLIERS



- Easily and quickly punches notches in sheet metal up to 2.0 mm thick.
- Saves the time-consuming filing of grooves for the anti-twist-protection of pushbuttons, switches and instruments.
- Notch sizes 3.2 mm and 4.8 mm possible.
- Max. material thickness 2.0 mm mild steel (S235).
- Notch punch can be exchanged.
- Long tool life because punch and die are made of hardened tool steel.
- Easy punching thanks to large leverage.
- Easy punching thanks to large leverage.
- Plastic-coated handles.
- Weight 1.3 kg

The notch punch is inserted into the pre-punched opening, aligned to the cross-hairs marking and then the pliers are actuated. A clean notch is the result!



Prod.-No. 03015

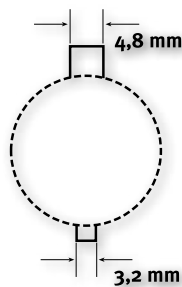

ALFRA notch pliers

Prod.-No.
03015

Spare parts

Notch punch with rivet pin

Prod.-No.
030151

